

# NuWaves

## RF Solutions

### NuFilter™ 04BPCV-1538.5-SFSF-M01 L-Band Bandpass Filter

1518 MHz to 1559 MHz

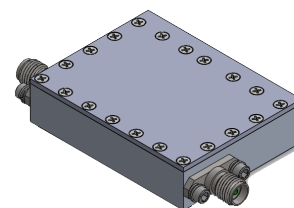

P/N: NW-FL-04BPCV-1538.5-SFSF-M01

**NuWaves' NuFilter™ 04BPCV-1538.5-SFSF-M01 is a small form bandpass RF filter designed specifically for compatibility with Inmarsat Downlink coms.**

The NuFilter 04BPCV-1538.5-SFSF-M01 provides superior harmonic and noise filtering, as demonstrated by the rejection levels of greater than 37 dB at 1450 and 1626 MHz. This high-performance module accepts input power levels up to 50 W, with only a minimal 1.5 dB of insertion loss in the passband frequency range of 1518 to 1559 MHz.

With standard SMA connectors, the NuFilter can be easily added to any RF system. NuWaves' NuFilter™ removes the time and cost burden of creating a design, laying out a PCB, buying parts, assembling, and testing. Allow NuWaves to save you time and money by outsourcing your filtering needs.

#### Features

- Minimal Passband Insertion Loss
- 41 MHz BW
- 50 W CW RF Power Handling
- Bandpass Filtering
- L-Band Operation
- Small Form Factor
- Lightweight
- Rugged Chassis

#### Applications

- Amplifier Harmonic Filtering
- Inmarsat Downlink Compatible
- Military Communications
- Avionics
- Point-to-Point Communications
- Software Defined Radios (SDRs)
- RF Filtering
- Test and Measurement

# NuFilter™ 04BPCV-1538.5-SFSF-M01

## Specifications

### Absolute Maximums

Parameter	Rating	Unit
Max RF Input Power, CW, $Z_L = 50 \Omega$	50	W
Max Operating Temperature	70	°C
Max Storage Temperature	85	°C

Export Classification
EAR99

### Electrical Specifications @ 25 °C, $Z_S=Z_L=50 \Omega$

Parameter	Symbol	Min	Typ	Max	Unit	Condition
Operating Frequency	BW	1518		1559	MHz	
Passband Insertion Loss	IL		0.9	1.5	dB	1518 MHz
			0.7	1		1538.5 MHz
			0.9	1.5		1559 MHz
Rejection		-37	-40		dB	1450 MHz
		-37	-40			1626 MHz
Passband Flatness			0.5	1	dB	
VSWR	VSWR		1.5			Within Passband

# NuFilter™ 04BPCV-1538.5-SFSF-M01

## Performance Plots

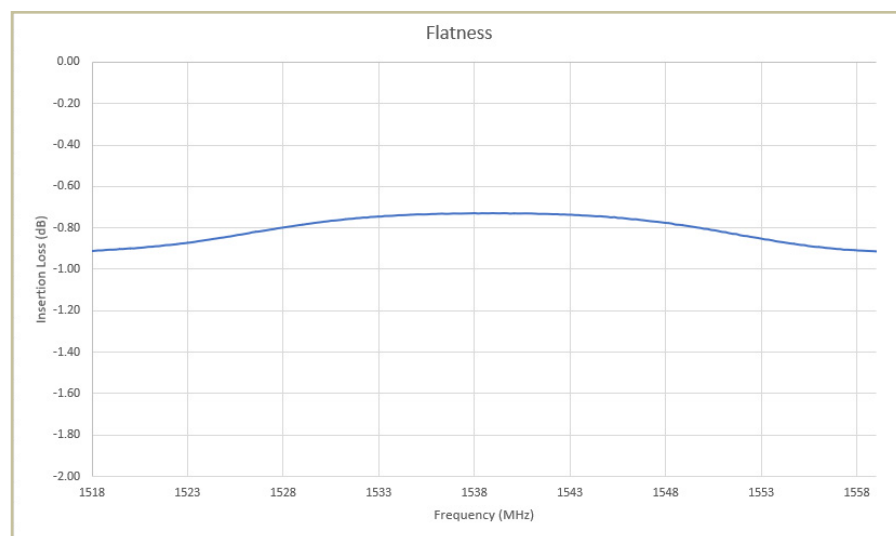
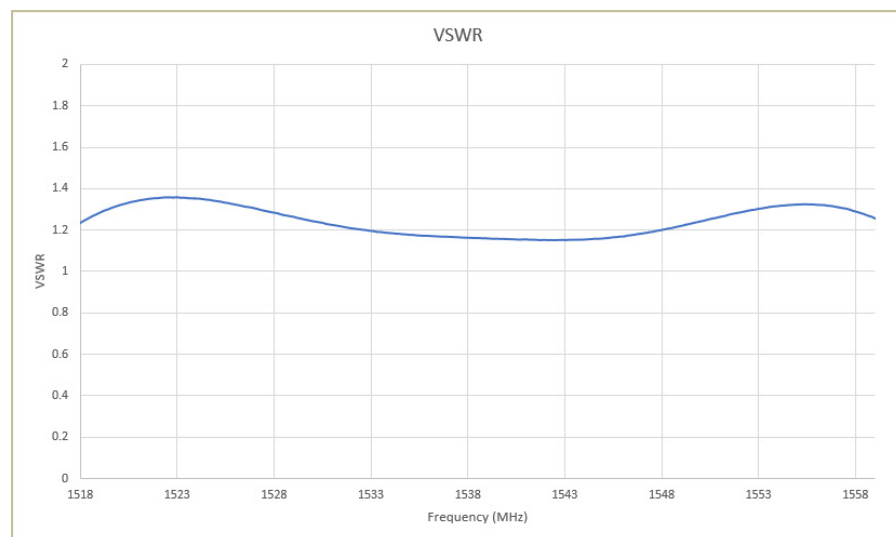
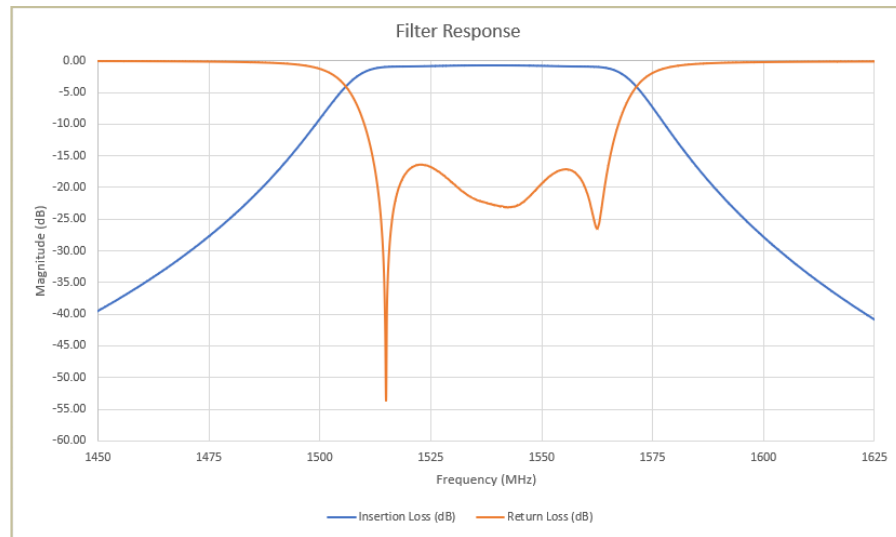

# NuFilter™ 04BPCV-1538.5-SFSF-M01

## Mechanical Specifications

Parameter	Value	Unit	Limits
Dimensions	1.85 x 1.42 x 0.45	in	Max
Weight	TBD	oz	Max
RF Connectors, Input/Output	SMA Female		
Finish	Silver Plating		

## Mechanical Outline

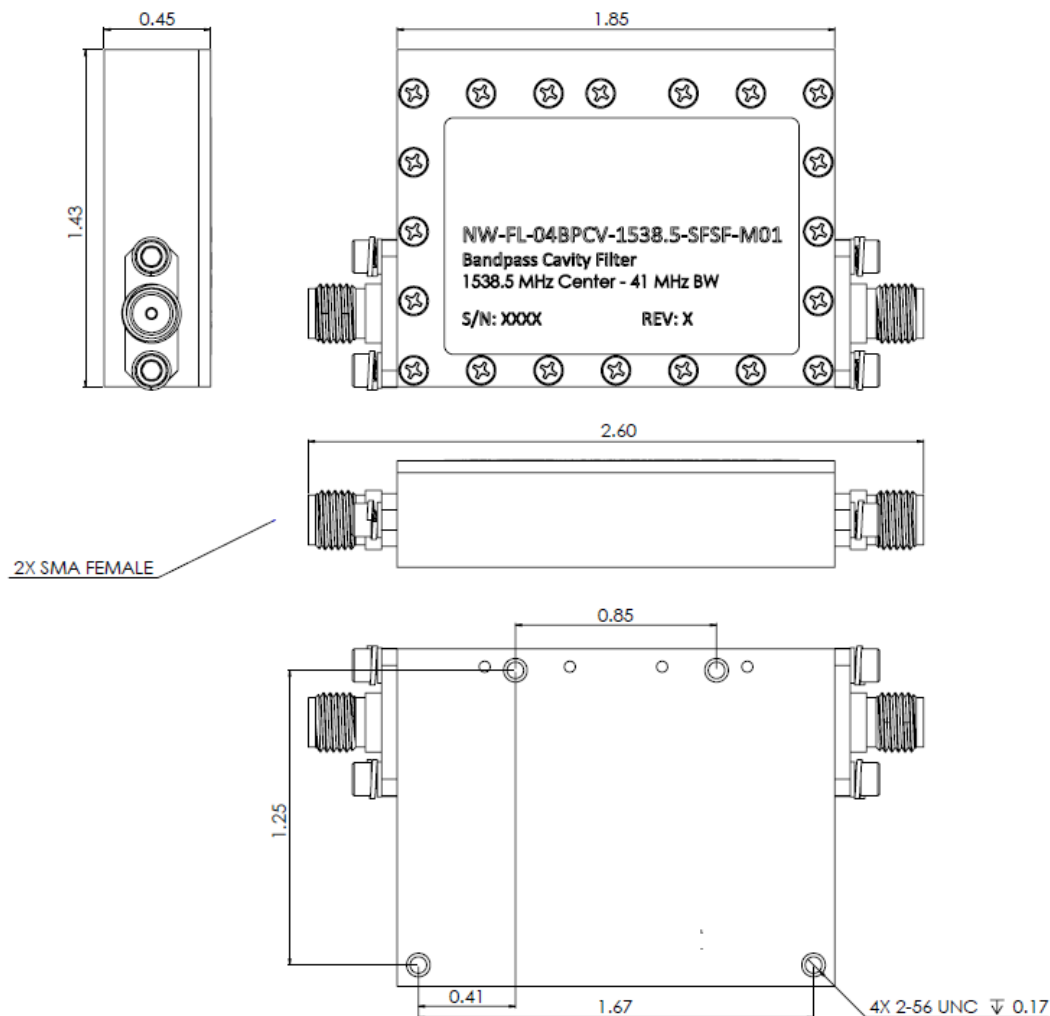

# NuFilter™ 04BPCV-1538.5-SFSF-M01

## Environmental Specifications

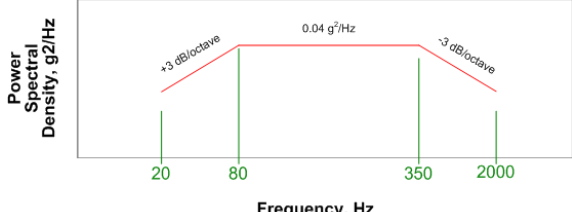
Parameter	Symbol	Min	Typ	Max	Unit
Operating Temperature	T <sub>C</sub>	-40		+70	°C
Storage Temperature	T <sub>STG</sub>	-40		+85	°C
Relative Humidity (non-condensing)	RH			95	%
Altitude MIL-STD-810F - Method 500.4	ALT			30,000	ft
Vibration / Shock Profile (Random profile in x,y, z axis, as per Figure for 15 minute duration in each axis)					

## Part Numbering Format

Part Number Example:

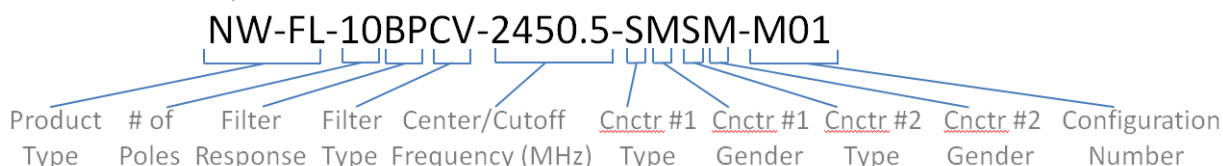

Number of Poles: 01 to 12 (2 digits)

Connector Type: S (SMA)  
B (BNC)  
T (TNC)

Filter Response: BP (Bandpass)  
LP (Lowpass)  
HP (Highpass)  
BR (Band Reject-Notch)

Connector Gender: M (Male)  
F (Female)

Filter Type: CV (Cavity)  
LE Lumped Element  
SL (Stripline)

Configuration #: Mxx (defines additional mechanical & spec elements)

For information on product disposal (end-of-life), please refer to this document:  
<https://nuwaves.com/wp-content/uploads/Product-Disposal-End-of-Life.pdf>

## Contact NuWaves



NuWaves RF Solutions  
132 Edison Drive  
Middletown, OH 45044

[www.nuwaves.com](http://www.nuwaves.com)  
[sales@nuwaves.com](mailto:sales@nuwaves.com)  
513.360.0800

